

Existing space for TBC& DST Lab, Ground Floor, Kakatiya Medical College, Warangal

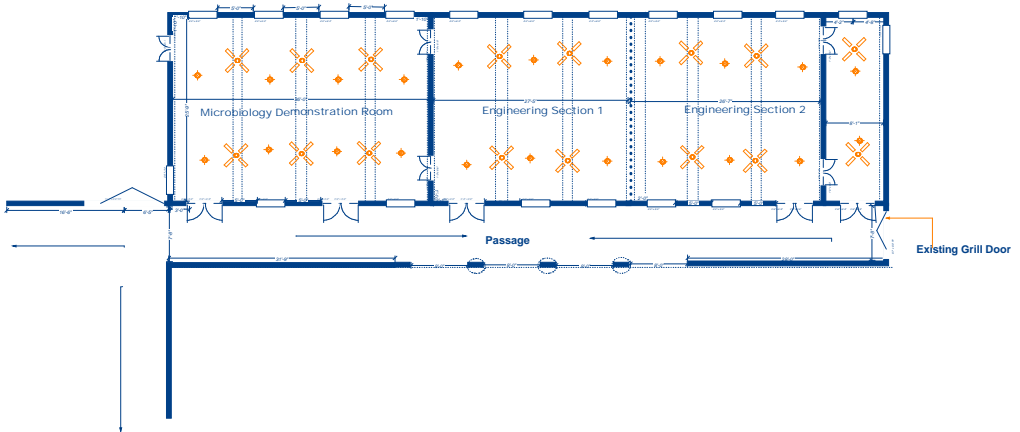

## Proposed Sections of TB C&amp; DST Lab, Ground Floor, Kakatiya Medical College, Warangal

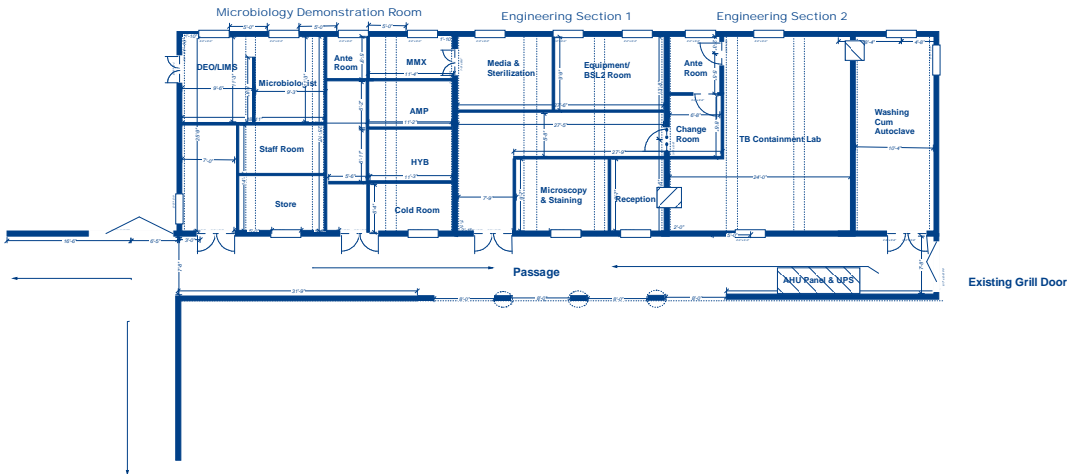

Proposed TB Containment & Autoclave cum washing Room  
Ground Floor, Kakatiya Medical College, Warangal

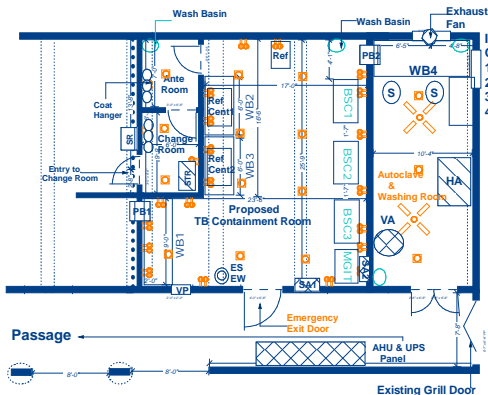

**Internal Dimensions:**

Overall Internal Dimension: 25'9" X 23'6"

1. Area of Change Room: 8'6" X 6'
2. Area of Ante Room: 7' X 6'
3. Area of TB containment Room: 16'6" X 17'+9' X 23'6"
4. Area of Autoclave & Washing Room: 25'9" X 10'4"

**Equipment Details:**

**TB Containment Lab**

BSC: Bio-safety Cabinet

RF: Refrigerator

Ref. Cent: Refrigerated Centrifuge

SA: Split AC (2 TR)

MGIT: MGIT 960

**Autoclave & Washing Room:**

VA: Vertical Autoclave

HA: Horizontal Autoclave

Exhaust Fan

**Note:**

Space for AHU ODU placement is identified on the roof top at the 2nd Floor, parallel to the proposed TB Containment Room

PB: Pass box (2'x2')(2 no)

WB1: Work Bench1 (LxWxH)(9'x3'x2'6")

WB2: Work Bench2 (LxWxH)(6'x3'x2'6")

WB3: Work Bench3 (LxWxH)(6'x3'x2'6")

WB4: Work Bench 4 L shape (LxWxH)(10'X3'X2'6"+5' X3'X2'6")

STR: Storage cabinet (LxWxH)(3'X1'6"x4')

ES & EW: Emergency Shower and Eye Wash

TR: Trolley (2'x1'6"):4 nos

S: Revolving Stools (5 nos.)

SR: Shoe Rack (2'x1')

VP: View Panel(1 no)